

Instructions: Frame with Mat

Watch the video online!

Scan the QR code:



Or go to:

www.framingonline.co.nz/Tutorials

1. Ready to assemble.



2. Place the frame face-down & bend the tabs back.



3. Remove backing board & matboard by lifting both out, leaving the glass in the frame.



4. Separate the mat from the backing board & place your item face-up on the backing board.

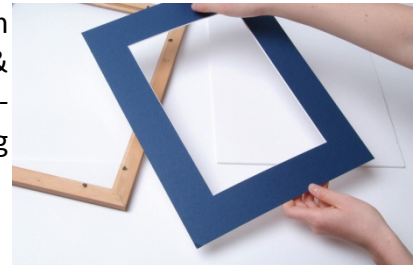

5. Peel hinging tape off the paper. Attach 2 strips to the top rear side of your item – half on your item, half above.

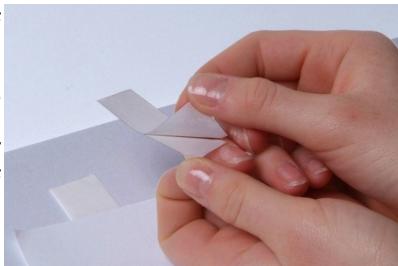

6. Hold the mat face-up & align it centrally over your item then press down.



7. Carefully turn over the mat & your item. Apply firm pressure to the hinging tape to ensure it bonds well.



8. Insert your hinged item into the frame face-down against the glass & place the backing board on top.

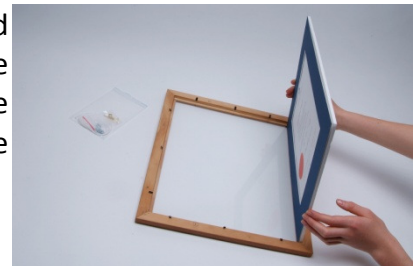

9. Bend the tabs back down.



10. Ready for cord.

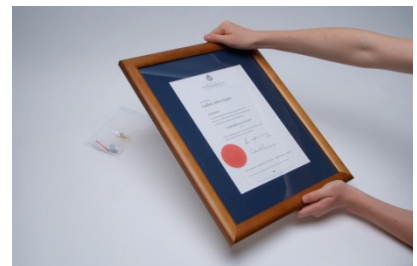

Turn page over for tying cord...